

5.11.4.1.4 TRANSVERSE REINFORCEMENT FOR CONFINEMENT AT PLASTIC HINGES

The commentary for this article specifies a maximum spacing of 8" center-center of longitudinal bars.

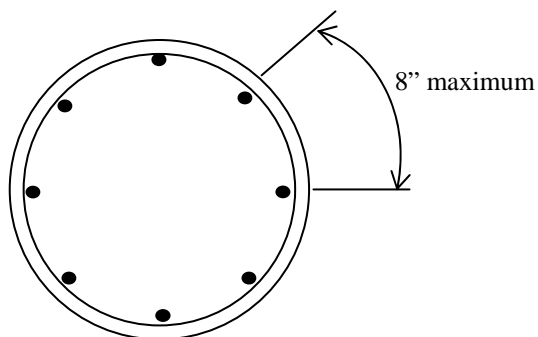

Interlocking spirals shall be used for non-circular columns. Reinforcement details are shown in the following sketch.

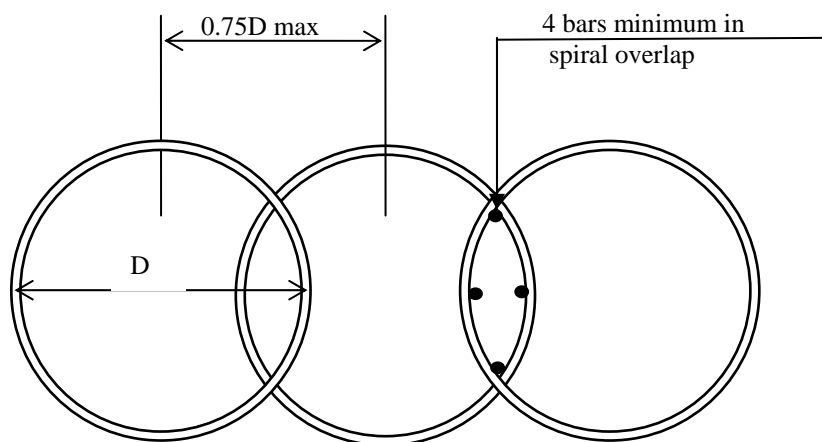

Revisions:
Oct 2017

Renumbered article from 5.10.11.4.1d to 5.11.4.1.4 to conform to the 8th Edition of the AASHTO LRFD Bridge Design Specifications.